

ROUSH

THE ART OF PERFORMANCE ENGINEERING

Installation Notes:

- Recommended application temperature, 70° - 80°F.
- Mating surfaces must be clean and free of any silicone adhesive, oils or debris.
- Do not touch the adhesive after the backing paper is removed.
- The GT Badge is attached with melted plastic pins that must be broken.

GT Dome Badge Removal

1. Insert a nylon pick tool between the base and chrome ring as shown in Figure 1. Carefully pry the chrome ring and GT badge upward snapping the five (5) plastic pins.

Note: If a nylon pick tool is not available, a popsicle stick, plastic ruler, plastic putty knife, plastic squeegee, etc may be used. The key is to use a tool that will not scratch or mar the chrome ring and base.

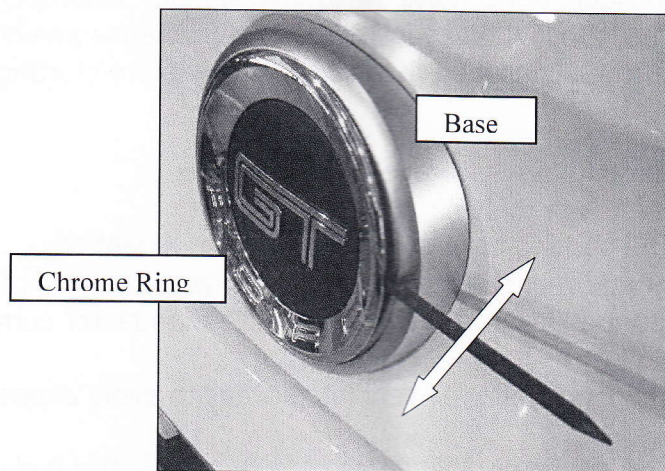

Figure 1

2. From the back side of the chrome ring, remove the GT badge from the chrome ring as shown in Figure 2.



Figure 2

ROUSH

THE ART OF PERFORMANCE ENGINEERING

3. Using a razor blade or similar equipment, remove the residual silicone adhesive from the base and both sides of the chrome ring. Refer to Figure 3.
4. Remove any high spots or remaining material on the base from the plastic pins of the GT badge. This surface must be clean and flat for a tight bond.

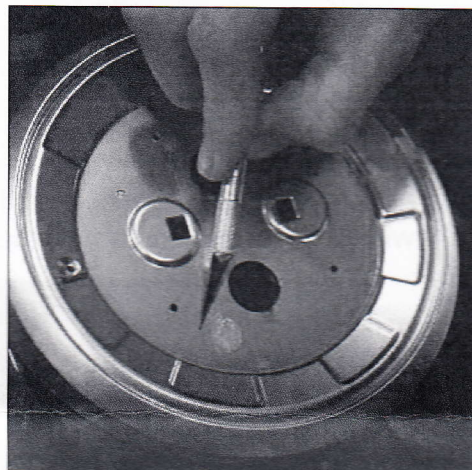

Figure 3

5. Using a lint free cloth and Isopropyl Alcohol, clean the base and both sides of the chrome ring. Refer to Figure 4.



Figure 4

Dome Badge Installation

6. Peel the white backing paper from the Die Cut Tape. Avoid finger contact to the adhesive. Apply the Die Cut Tape to the back side of the chrome ring, aligning the holes as shown in Figure 5. Avoid trapping air bubbles under the tape.

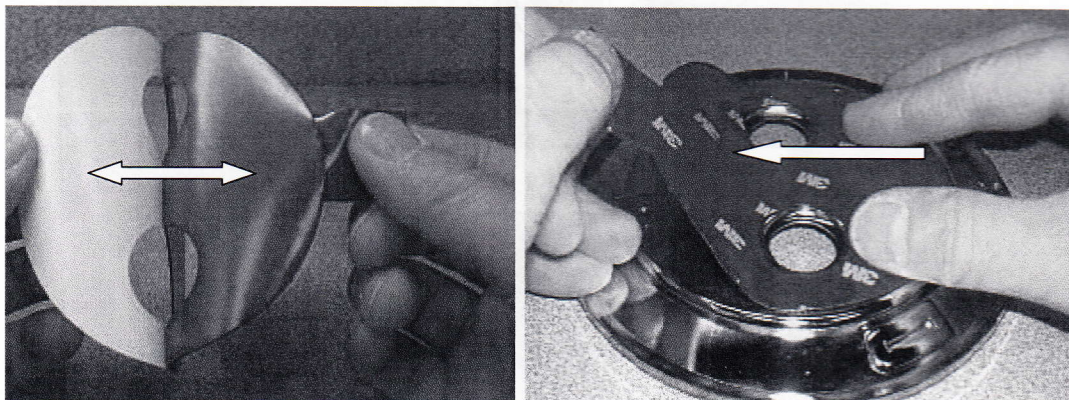

Figure 5

ROUSH

THE ART OF PERFORMANCE ENGINEERING

7. Flip the chrome ring over. Peel the red backing paper from the Die Cut Spacer. Avoid finger contact to the adhesive. Apply the spacer to the chrome ring as shown in Figure 6.

Note: The Die Cut Spacer is a smaller diameter than the hole in the chrome ring. Make every effort to apply the spacer into the center. There should be a 1 mm gap around the perimeter of the Die Cut Spacer. Attempt to line up the 2 holes. This will allow for full contact of the tape.

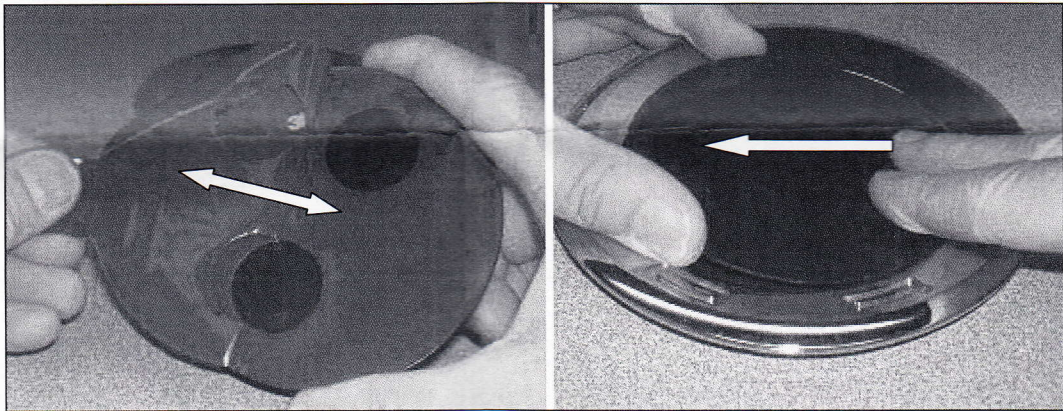

Figure 6

8. Peel the red backing paper from the Die Cut Tape and apply the chrome ring to the dome badge base. Refer to Figure 7. Ensure the pin on the back of the chrome ring aligns to the hole on the edge of the base. This will center the FORD logo. Apply firm pressure to the center and outward for a tight bond.

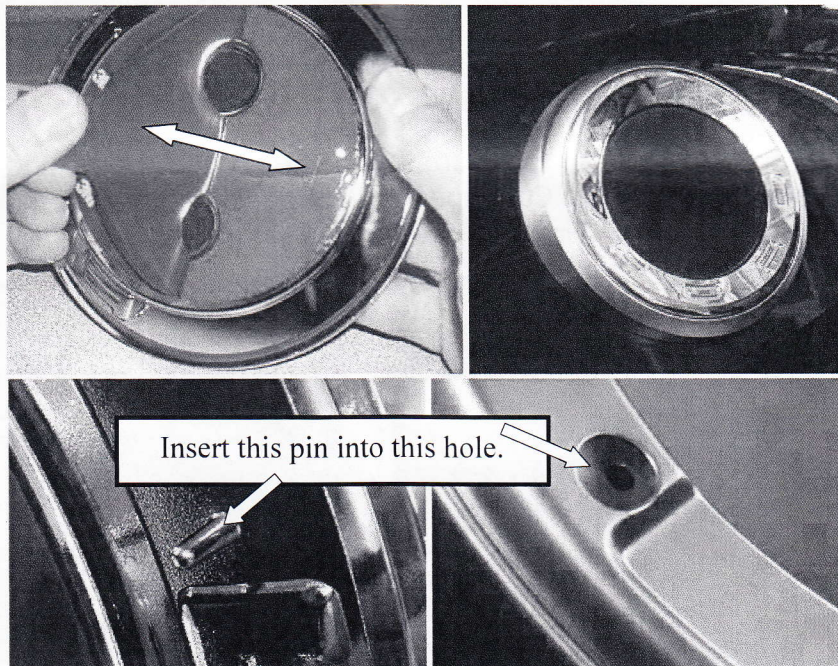

Figure 7

ROUSH

THE ART OF PERFORMANCE ENGINEERING

9. Using a lint free cloth and Isopropyl Alcohol, clean the surface of the black Die Cut Spacer.
10. Remove the white backing paper from the back side of the Dome Badge. Avoid finger contact to the adhesive and trapping air bubbles under the badge. Using a steady hand and a keen eye, apply the Dome Badge to the Die Cut Spacer. Refer to Figure 8. Once installed, apply firm pressure to the center and outward for a tight bond.

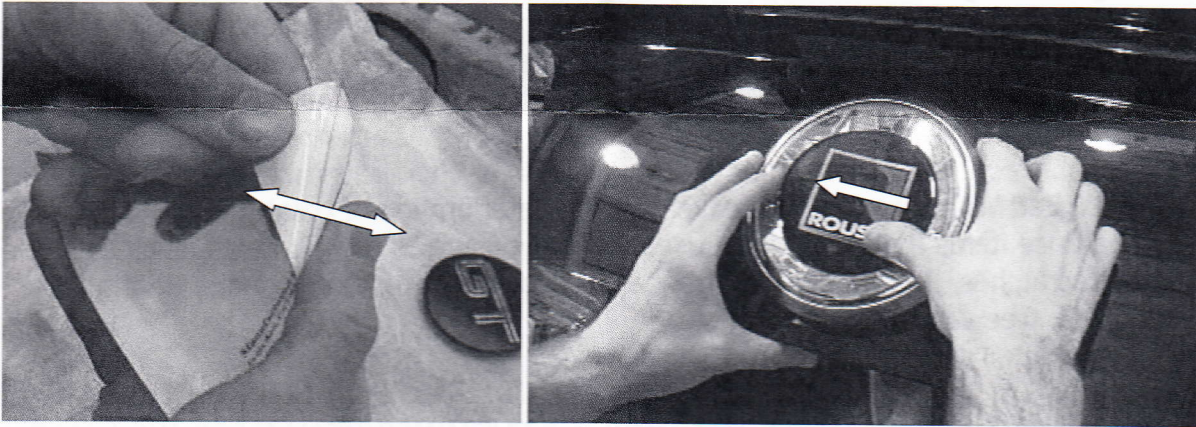

Figure 8

Congratulations!!! You have completed the installation of the ROUSH Performance Products, Dome Badge Kit. It is recommended that you save all parts removed from your vehicle during the installation of this kit.

